

P-Channel Logic Level Enhancement Mode Field Effect Transistor

Product Summary:

| | |
|---------------------|--------------|
| BV_{DSS} | -20V |
| $R_{DS(on)}$ (MAX.) | 20m Ω |
| I_D | -8.5A |

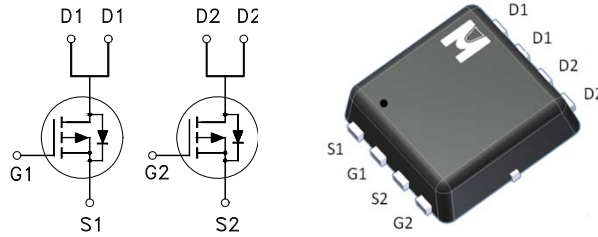

Pb-Free Lead Plating & Halogen Free



ABSOLUTE MAXIMUM RATINGS ($T_A = 25\text{ }^\circ\text{C}$ Unless Otherwise Noted)

| PARAMETERS/TEST CONDITIONS | | SYMBOL | LIMITS | UNIT |
|--|----------------------------------|------------------|------------|------------------|
| Gate-Source Voltage | | V_{GS} | ± 12 | V |
| Continuous Drain Current | $T_A = 25\text{ }^\circ\text{C}$ | I_D | -8.5 | A |
| | $T_A = 70\text{ }^\circ\text{C}$ | | -6 | |
| Pulsed Drain Current ¹ | | I_{DM} | -34 | |
| Power Dissipation | $T_A = 25\text{ }^\circ\text{C}$ | P_D | 2 | W |
| | $T_A = 70\text{ }^\circ\text{C}$ | | 1.28 | |
| Operating Junction & Storage Temperature Range | | T_{j}, T_{stg} | -55 to 150 | $^\circ\text{C}$ |

THERMAL RESISTANCE RATINGS

| THERMAL RESISTANCE | SYMBOL | TYPICAL | MAXIMUM | UNIT |
|----------------------------------|-----------------|---------|---------|-----------------------------|
| Junction-to-Case | $R_{\theta JC}$ | | 25 | $^\circ\text{C} / \text{W}$ |
| Junction-to-Ambient ³ | $R_{\theta JA}$ | | 62.5 | |

¹Pulse width limited by maximum junction temperature.

²Duty cycle $\leq 1\%$

³62.5 $^\circ\text{C} / \text{W}$ when mounted on a 1 in² pad of 2 oz copper.

ELECTRICAL CHARACTERISTICS ($T_A = 25\text{ }^\circ\text{C}$, Unless Otherwise Noted)

| PARAMETER | SYMBOL | TEST CONDITIONS | LIMITS | | | UNIT | | |
|---|---------------------|---|--|-------|-----------|-----------|--|------|
| | | | MIN | TYP | MAX | | | |
| STATIC | | | | | | | | |
| Drain-Source Breakdown Voltage | $V_{(BR)DSS}$ | $V_{GS} = 0V, I_D = -250\mu A$ | -20 | | | V | | |
| Gate Threshold Voltage | $V_{GS(th)}$ | $V_{DS} = V_{GS}, I_D = -250\mu A$ | -0.4 | -0.75 | -1.2 | | | |
| Gate-Body Leakage | I_{GSS} | $V_{DS} = 0V, V_{GS} = \pm 12V$ | | | ± 100 | nA | | |
| Zero Gate Voltage Drain Current | I_{DSS} | $V_{DS} = -16V, V_{GS} = 0V$ | | | -1 | μA | | |
| | | $V_{DS} = -12V, V_{GS} = 0V, T_J = 125\text{ }^\circ\text{C}$ | | | -10 | | | |
| On-State Drain Current ¹ | $I_{D(ON)}$ | $V_{DS} = -5V, V_{GS} = -4.5V$ | -8.5 | | | A | | |
| Drain-Source On-State Resistance ¹ | $R_{DS(ON)}$ | $V_{GS} = -4.5V, I_D = -8.5A$ | | 15 | 20 | $m\Omega$ | | |
| | | $V_{GS} = -2.5V, I_D = -4.5A$ | | 19 | 25 | | | |
| | | $V_{GS} = -1.8V, I_D = -2.5A$ | | 26 | 40 | | | |
| Forward Transconductance ¹ | g_{fs} | $V_{DS} = -5V, I_D = -8.5A$ | | 22 | | S | | |
| DYNAMIC | | | | | | | | |
| Input Capacitance | C_{iss} | $V_{GS} = 0V, V_{DS} = -10V, f = 1MHz$ | | 3050 | | pF | | |
| Output Capacitance | C_{oss} | | | 460 | | | | |
| Reverse Transfer Capacitance | C_{rss} | | | 410 | | | | |
| Total Gate Charge ^{1,2} | $Q_g(V_{GS}=-4.5V)$ | $V_{DS} = -10V, V_{GS} = -4.5V, I_D = -8.5A$ | | 27 | | nC | | |
| | $Q_g(V_{GS}=-2.5V)$ | | | 16.5 | | | | |
| Gate-Source Charge ^{1,2} | Q_{gs} | | | 2.2 | | | | |
| Gate-Drain Charge ^{1,2} | Q_{gd} | | | 6.8 | | | | |
| Turn-On Delay Time ^{1,2} | $t_{d(on)}$ | | $V_{DS} = -10V, I_D = -1A, V_{GS} = -4.5V, R_{GS} = 6\Omega$ | | 20 | | | nS |
| Rise Time ^{1,2} | t_r | | | | 50 | | | |
| Turn-Off Delay Time ^{1,2} | $t_{d(off)}$ | | | 90 | | | | |
| Fall Time ^{1,2} | t_f | | | 60 | | | | |
| SOURCE-DRAIN DIODE RATINGS AND CHARACTERISTICS ($T_C = 25\text{ }^\circ\text{C}$) | | | | | | | | |
| Continuous Current | I_S | | | | -2.3 | A | | |
| Pulsed Current ³ | I_{SM} | | | | -9.2 | | | |
| Forward Voltage ¹ | V_{SD} | $I_F = I_S, V_{GS} = 0V$ | | | -1.2 | V | | |

¹Pulse test : Pulse Width $\leq 300\ \mu\text{sec}$, Duty Cycle $\leq 2\%$.

²Independent of operating temperature.

³Pulse width limited by maximum junction temperature.

Ordering & Marking Information:

Device Name: EMF20B02V for EDFN 3 x 3

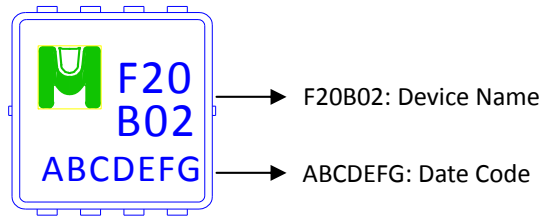

Outline Drawing

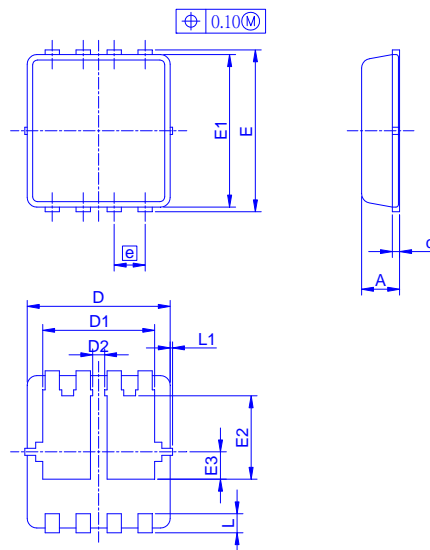

Dimension in mm

| Dimension | A | A1 | b | c | D | D1 | D2 | E | E1 | E2 | E3 | e | L | L1 | θ1 |
|-----------|------|------|------|-------|------|------|-------|------|------|------|-------|------|------|------|-----|
| Min. | 0.70 | 0 | 0.24 | 0.10 | 2.95 | 2.25 | | 3.15 | 2.95 | 1.65 | | | 0.30 | 0 | 0° |
| Typ. | 0.80 | | 0.30 | 0.152 | 3.00 | 2.35 | 0.225 | 3.20 | 3.00 | 1.75 | 0.575 | 0.65 | 0.40 | | 10° |
| Max. | 0.90 | 0.05 | 0.35 | 0.25 | 3.05 | 2.45 | | 3.25 | 3.05 | 1.85 | | | 0.50 | 0.10 | 12° |

Recommended minimum pads

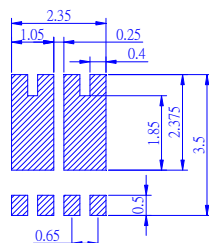



TYPICAL CHARACTERISTICS

